

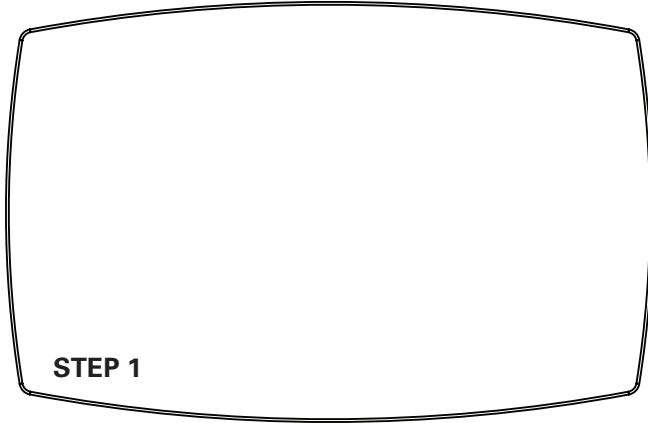

SCREEN ASSEMBLY

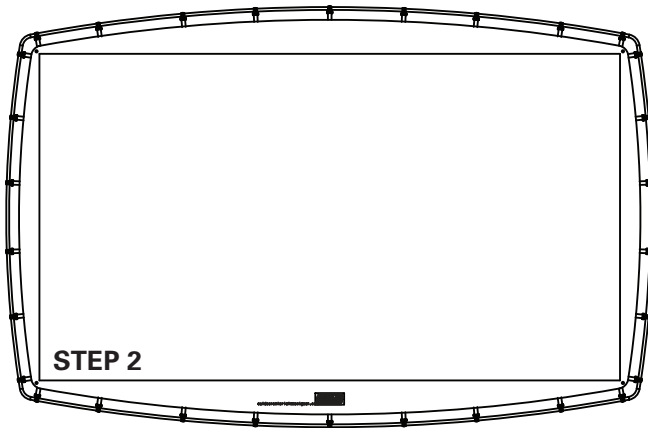

1. Assemble each half of the frame separately then connect the two halves together.



2. Attach the clips to the frame, starting with the four corners.

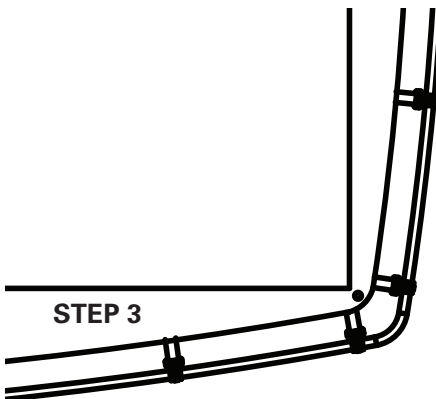

3. Tighten the screen using the adjustable straps on the right and bottom sides of the movie screen.

CAUTION: Evenly adjust straps to remove wrinkles. Do not over tighten. Over tightening will cause the frame to twist. If frame twists loosen the straps.





This screen can be hung many different ways. It can be hung from walls or fence using the supplied hardware. With a little ingenuity, this screen can be hung from trees, rain gutters, etc. A leg kit accessory for a free standing screen is also available at www.outdoorentertainmentgear.com



HANGING INSTRUCTIONS

1. Clip Strap to the top corner of the frame, and adjust the strap as needed. Repeat on other four corners.



2. Hang straps on included hook screws. **NOTE:** Command Strips can be purchased at your local hardware store if you don't want to put holes in your interior/exterior walls.)

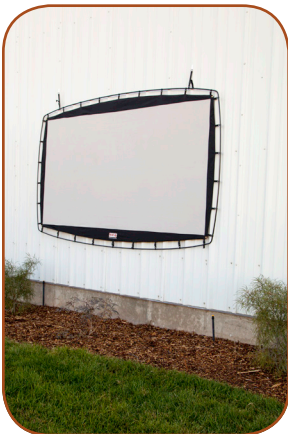

www.outdoorentertainmentgear.com

